

Two bedroom
APARTMENTS
TYPE 1A & 1B

SOUTH BLOCK

NORTH BLOCK



South Block - 1B

1. SG12 · 2. SI12 · 3. S212 · 4. S312 · 5. S412

North Block - 1A

6. NG01 · 7. NI01 · 8. N201 · 9. N301 · 10. N401

Type 1A

2 BEDROOM APARTMENT

Internal Floor Area 103 m²
Covered Terrace Area 34 m²
Gross Floor Area 138 m²

LEGEND

- 1. Bedroom 1
- 2. En-suite
- 3. Bedroom 2
- 4. Bathroom
- 5. Living Room / Kitchen
- 6. Covered Terrace



Type 1B

2 BEDROOM APARTMENT

Internal Floor Area 130 m²
Covered Terrace Area 50 m²
Gross Floor Area 180 m²

LEGEND

- 1. Bedroom 1
- 2. En-suite
- 3. Bedroom 2
- 4. Bathroom
- 5. Living Room / Kitchen
- 6. Covered Terrace

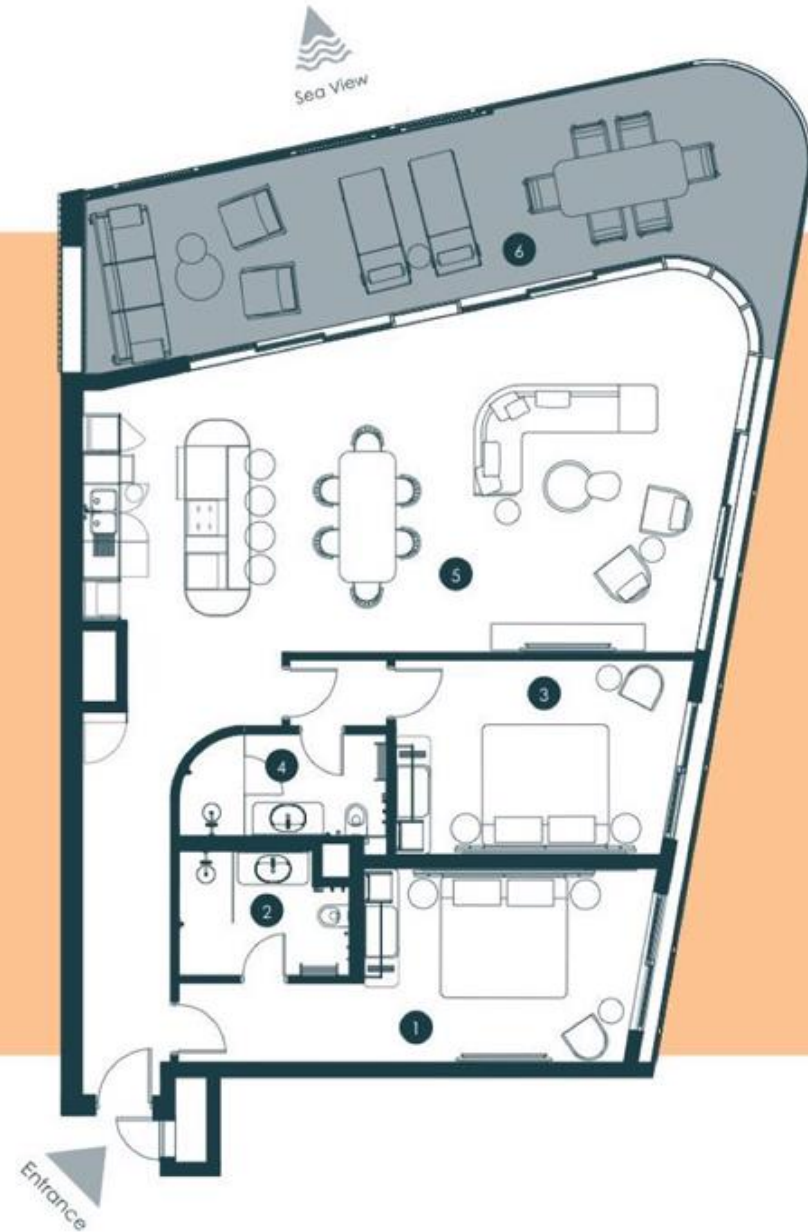

Two bedroom APARTMENTS

TYPE 3A & 3B

SOUTH BLOCK

NORTH BLOCK



South Block

- | | | | | | |
|--------------|---------------|---------------|---------------|---------------|---------------|
| 1. SG10 3B | 6. S110 3B | 11. S210 3B | 16. S310 3B | 21. S410 3B | 26. S505 3A |
| 2. SG09 3A | 7. S109 3A | 12. S209 3A | 17. S309 3A | 22. S409 3A | 27. S504 3B |
| 3. SG08 3B | 8. S108 3B | 13. S208 3B | 18. S308 3B | 23. S408 3B | |
| 4. SG07 3A | 9. S107 3A | 14. S207 3A | 19. S307 3A | 24. S407 3A | |
| 5. SG06 3B | 10. S106 3B | 15. S206 3B | 20. S306 3B | 25. S406 3B | |

North Block

- | | | |
|---------------|---------------|---------------|
| 28. NG05 3A | 33. N103 3A | 38. N304 3B |
| 29. NG04 3B | 34. N205 3A | 39. N303 3A |
| 30. NG03 3A | 35. N204 3B | 40. N405 3A |
| 31. N105 3A | 36. N203 3A | 41. N404 3B |
| 32. N104 3B | 37. N305 3A | 42. N403 3A |

Type 3A

2 BEDROOM APARTMENT

Internal Floor Area 84 m²
Covered Terrace Area 16 m²
Gross Floor Area 100 m²

LEGEND

- 1. Bedroom 1
- 2. En-suite
- 3. Bedroom 2
- 4. Bathroom
- 5. Living Room / Kitchen
- 6. Covered Terrace



Type 3B

2 BEDROOM APARTMENT

Internal Floor Area 84 m²
Covered Terrace Area 14 m²
Gross Floor Area 99 m²

LEGEND

- 1. Bedroom 1
- 2. En-suite
- 3. Bedroom 2
- 4. Bathroom
- 5. Living Room / Kitchen
- 6. Covered Terrace

